

THESE DRAWINGS AND SPECIFICATIONS ARE THE PROPERTY OF JBL INCORPORATED. THEY ARE ISSUED IN STRICT CONFIDENCE AND SHALL NOT BE REPRODUCED OR USED AS THE BASIS FOR MANUFACTURE OR APPARATUS WITHOUT WRITTEN PERMISSION.

ALL MATERIAL SPECIFIED ON THIS DRAWING SHALL CONTINUALLY COMPLY WITH THE EFFECTIVE EU RoHS DIRECTIVE, CURRENTLY 2011/65/EU, INCLUDING ALL AMENDMENTS.

| REVISIONS | | | | |
|-----------|-----------------|------|----------|------|
| LTR | DESCRIPTION | DRFT | DATE | APPR |
| A | INITIAL RELEASE | kw | 07/06/24 | |
| B | UPDATE WEIGHT | kw | 10/30/24 | |

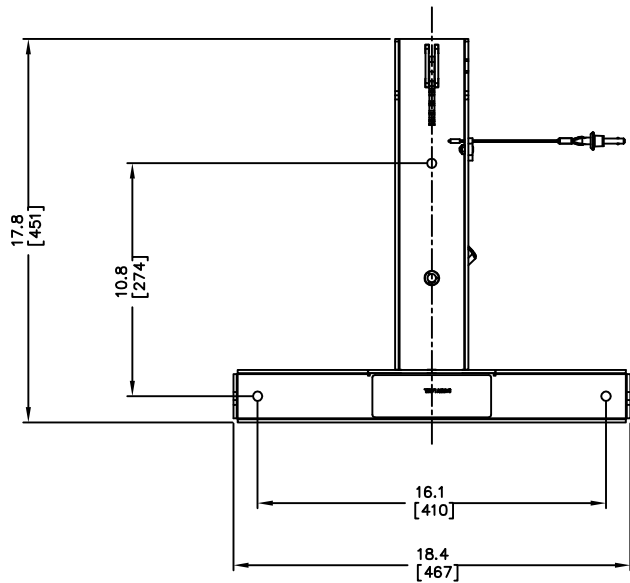

TOP

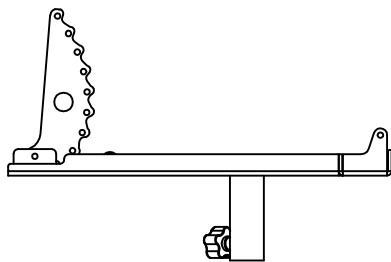

LEFT

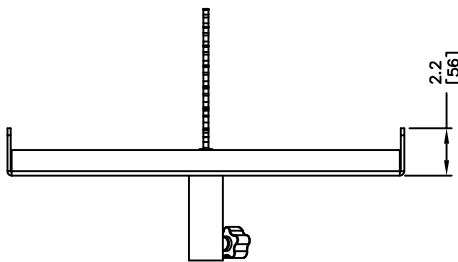

FRONT

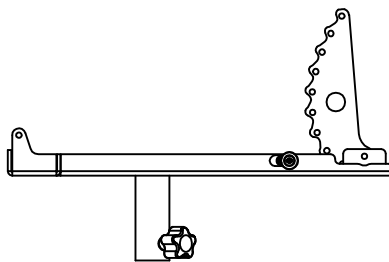

RIGHT

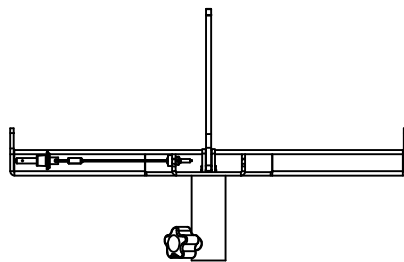

BACK

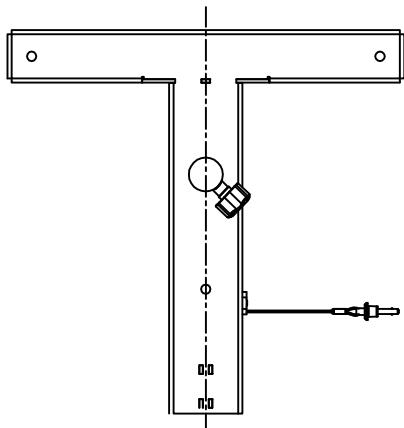

BOTTOM

3. WEIGHT: 4.0 KG (9 LBS).
2. FINISH: BLACK POWDER COATING.
1. MATERIAL: SPCC, T=4.0MM
- NOTES: (UNLESS OTHERWISE SPECIFIED)

| TOLERANCES (UNLESS OTHERWISE SPECIFIED) | |
|--|--|
| X.XX ± .063INCH | |
| X.X ± .125INCH | |
| ANGULAR TOLERANCE OF 0°±30° | |
| FRACTIONAL DIMENSIONS ± 1/32 | |
| * DIMENSIONS ARE INCHES INCHES [MM] | |
| * ALL DIMENSIONS ARE FINISHED DIMENSIONS | |
| * DO NOT SCALE DRAWING | |

| | | | |
|--|---------------------------|---|-----------------|
| HARMAN | | JBL Professional 8500 Balboa Blvd Northridge, CA 91329 USA | |
| TITLE CUSTOMER DRAWING: SRX906LA PM | | | |
| SIZE A | DRAWING NO. 1000380790 | | REV B |
| SCALE NTS | | SHEET 1 OF 1 | |